



700 Series Air Torque Actuated Ball Valves

Applications

Remote ball valve actuation applications such as; Compressor Blow-down, Dispenser sequencing, Isolation, Priority Panels, Storage, Mobile Storage & Transport Trailers. Suitable for CNG, Hydrogen, Helium, Bio-Gas, Nitrogen, Air and other gases on enquiry.



BV704 with Air Torque AT101

Materials

Part Code	Description	Material
BV700 series	Ball Valves	As per product specification
AT	Air Torque	As per manufacturers specification
BVAC	Actuator Mount Bracket, Drive Dog and Bolts	304 Stainless Steel

Product Information

Full range of valves available from 1/4" to 1".

3/4" valve tested to NGV4.6 option available on request.

NPT or SAE female thread is standard configuration. Other threads available upon request.

NPT threads conform to ASME B1.20.1.

SAE threads conform to SAE J1926-1.

Complies to PED 2014/68/EU.

CRN (OC12117.2C) approved for all provinces.

Separate part numbers for "Normally Open" and "Normally Closed" configurations.

All Oasis products are manufactured under ISO 9001 accredited standards.

Video servicing instructions available online at www.OasisNGV.com/resources.

Features & Benefits

Oasis provides actuated ball valves, factory fitted and tested for your convenience.

Featuring a floating drive dog, that dampens vibration - extending the life of the valve.

A carefully aligned, rigid bracket ensures minimal lateral torque.

Simple design, easy maintenance.

Economical on space.

Sturdy, rigid stainless steel construction.

Supplied with Air Torque (www.AirTorque.it) actuators.

Low Oasis valve opening torque means small actuators can be specified when compared to competitor valves.



700 Series Air Torque Actuated Ball Valves

NPT Product Specification

Part Code	Mass lb (kg)	Min. Operating Pressure bar (psi) *	Max. Operating Pressure bar (psi) **	Min. Temp. °F (°C)	Max Temp. °F (°C)	Actuator Supply Pressure bar (psi) ^	Actuator Air Supply Port Size	Stem Open Torque ft-lb (Nm)^^	Cv
BV702-4N6SDDN-0122 (N/C) BV702-4N6SDDN-012L (N/O)	3.3 (1.5)	34.5 (500)	410 (6000)	-40 (-40)	185 (85)	6-8 (87-116)	1/8" BSPP	1.1 (1.5)	4.5
BV703-4N6SDDN-0122 (N/C) BV703-4N6SDDN-012L (N/O)	3.5 (1.6)	34.5 (500)	410 (6000)	-40 (-40)	185 (85)	6-8 (87-116)	1/8" BSPP	2.2 (3)	9.3
BV704-4N6LDDN-0124 (N/C) BV704-4N6LDDN-012M (N/O)	5.1 (2.3)	0.5 (7)	410 (6000)	-40 (-40)	185 (85)	6-8 (87-116)	1/8" BSPP	10.3 (14)	12.3
BV706-4N6LDDN-0146 (N/C) BV706-4N6LDDN-014N (N/O)	12.5 (5.7)	0.5 (7)	410 (6000)	-40 (-40)	185 (85)	6-8 (87-116)	1/8" BSPP	22.8 (31)	31
BV708-4N6LDDN-0148 (N/C) BV708-4N6LDDN-014P (N/O)	18.7 (8.5)	0.5 (7)	410 (6000)	-40 (-40)	185 (85)	6-8 (87-116)	1/8" BSPP	32.4 (44)	44.5

SAE Product Specification

Part Code	Mass lb (kg)	Min. Operating Pressure bar (psi) *	Max. Operating Pressure bar (psi) **	Min. Temp. °F (°C)	Max Temp. °F (°C)	Actuator Supply Pressure bar (psi) ^	Actuator Air Supply Port Size	Stem Open Torque ft-lb (Nm)^^	Cv
BV704-4S6LDDN-0124 (N/C) BV704-4S6LDDN-012M (N/O)	5.1 (2.3)	0.5 (7)	410 (6000)	-40 (-40)	185 (85)	6-8 (87-116)	1/8" BSPP	10.3 (14)	12.3
BV706-4S6LDDN-0146 (N/C) BV706-4S6LDDN-014N (N/O)	12.5 (5.7)	0.5 (7)	410 (6000)	-40 (-40)	185 (85)	6-8 (87-116)	1/8" BSPP	22.8 (31)	31
BV708-4S6LDDN-0148 (N/C) BV708-4S6LDDN-014P (N/O)	18.7 (8.5)	0.5 (7)	410 (6000)	-40 (-40)	185 (85)	6-8 (87-116)	1/8" BSPP	32.4 (44)	44.5

(N/C) Normally Closed - Valve is in closed position when no pressure applied to actuator.

(N/O) Normally Open - Valve is in open position when no pressure applied to actuator.

* Minimum system pressure the product will hold constant bubble tight seal.

** Maximum pressure at which the product can constantly operate at.

^ Required actuator supply pressure to operate Air Torque Actuator.

^^ Opening Torque at 6,000 psi.



700 Series Air Torque Actuated Ball Valves

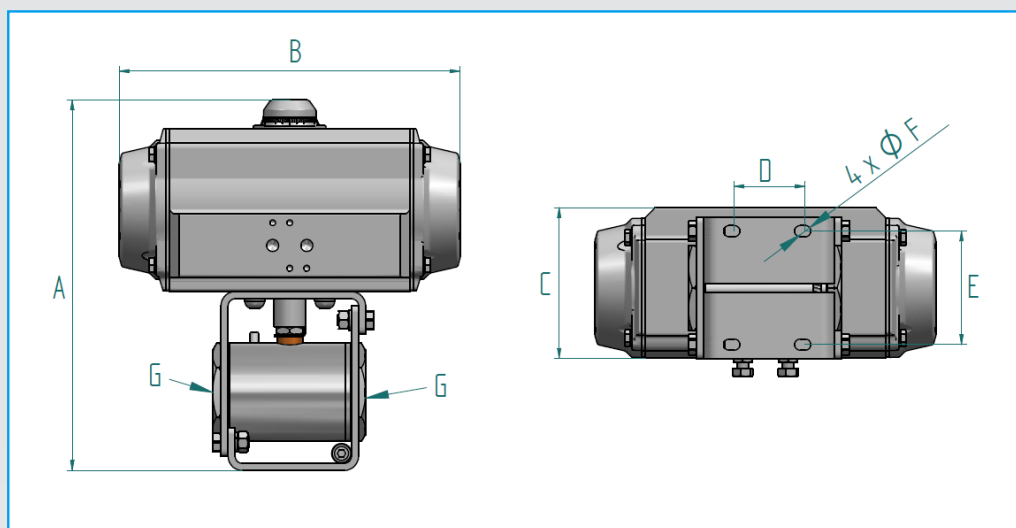

NPT Dimensions Inch (mm)

Part Code	Size	A	B	C	D	E	Ø F	(G) Port Thread	Actuator
BV702-4N6SDDN-0122 (N/C)	1/4"	5.78	5.55	2.79	N/A	N/A	N/A	1/4" NPT FEMALE	AT051
BV702-4N6SDDN-012L (N/O)		(147)	(141)	(71)					
BV703-4N6SDDN-0122 (N/C)	3/8"	5.78	5.55	2.79	N/A	N/A	N/A	3/8" NPT FEMALE	AT051
BV703-4N6SDDN-012L (N/O)		(147)	(141)	(71)					
BV704-4N6LDDN-0124 (N/C)	1/2"	6.7	6.26	3.26	N/A	N/A	N/A	1/2" NPT FEMALE	AT101
BV704-4N6LDDN-012M (N/O)		(170)	(159)	(83)					
BV706-4N6LDDN-0146 (N/C)	3/4"	9.33	8.3	3.74	1.97	2.36	0.32	3/4" NPT FEMALE	AT201
BV706-4N6LDDN-014N (N/O)		(237)	(211)	(95)	(50)	(60)	(8)		
BV708-4N6LDDN-0148 (N/C)	1"	10.27	9.7	4.17	1.97	3.15	0.32	1" NPT FEMALE	AT251
BV708-4N6LDDN-014P (N/O)		(261)	(248)	(106)	(50)	(80)	(8)		

SAE Dimensions Inch (mm)

Part Code	Size	A	B	C	D	E	Ø F	(G) Port Thread	Actuator
BV704-4S6LDDN-0124 (N/C)	1/2"	6.7	6.26	3.26	N/A	N/A	N/A	3/4-16 SAE FEMALE	AT101
BV704-4S6LDDN-012M (N/O)		(170)	(159)	(83)					
BV706-4S6LDDN-0146 (N/C)	3/4"	9.33	8.3	3.74	1.97	2.36	0.32	1 1/16 -12 SAE FEMALE	AT201
BV706-4S6LDDN-014N (N/O)		(237)	(211)	(95)	(50)	(60)	(8)		
BV708-4S6LDDN-0148 (N/C)	1"	10.27	9.7	4.17	1.97	3.15	0.32	1 5/16 -12 SAE FEMALE	AT251
BV708-4S6LDDN-014P (N/O)		(261)	(248)	(106)	(50)	(80)	(8)		

(N/C) Normally Closed - Valve is in closed position when no pressure applied to actuator.

(N/O) Normally Open - Valve is in open position when no pressure applied to actuator.