



# DM104

## Dispenser Manifold

### Instruction Manual

#### **▲ WARNING**

Failure to follow these instructions or to properly install and maintain this equipment could result in gas leakage, fire or explosion causing property damage and personal injury or death.

Oasis products must be installed, operated and maintained by trained and competent personnel in accordance with all applicable local codes, rules and regulations in addition to the Oasis Instructions.

Oasis Engineering Ltd. will not be held liable in such circumstances where installation, operation and maintenance procedures were performed by incompetent personnel resulting in improper assembly, unsafe operation, equipment damage or personal injury.

The Oasis 100 series CNG Dispenser Manifold & Accessories have been designed and manufactured in accordance with Sound Engineering Practice (SEP) and comply with the SEP requirements of the EC Pressure Equipment Directive 2014/68/EU.

Technical documents required by the Directive are held by the Manufacturer, Oasis Engineering Ltd

Oasis Engineering Ltd  
129 Birch Avenue, Tauranga, New Zealand.  
T: +64 7 928 3808  
E: [info@oasisNGV.com](mailto:info@oasisNGV.com)  
W: [www.OasisNGV.com](http://www.OasisNGV.com)



Instruction Manual

## Warning!

**High pressure gas and gas equipment can cause serious harm to both infrastructure and personnel if safety precautions are not followed.**

**Oasis recommends considering the use of the following PPE when working with high pressure along with any other site specific health and safety requirements:**



Foot Protection



Hearing Protection



Safety Helmets



Hand Protection



Safety Glasses



**Ensure the system is vented and isolated before any installation or servicing work is carried out.**

## Tools Required

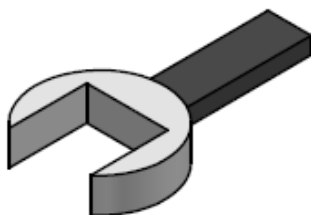

Spanner  
(Wrenches)



Anti Seize Grease  
- Swagelok Silver Goop  
- Omega 99  
- or similar

1. Mount the manifold.

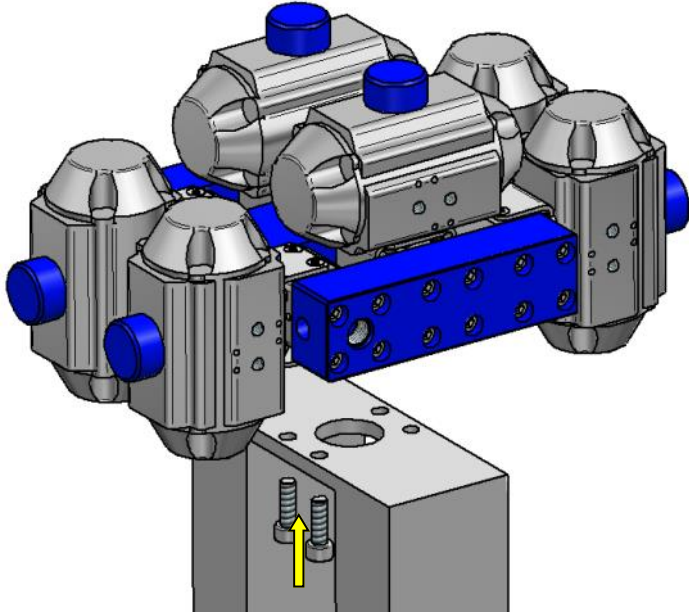

2. Attach center inlet connection first.  
**Recommended torque = 50Nm**

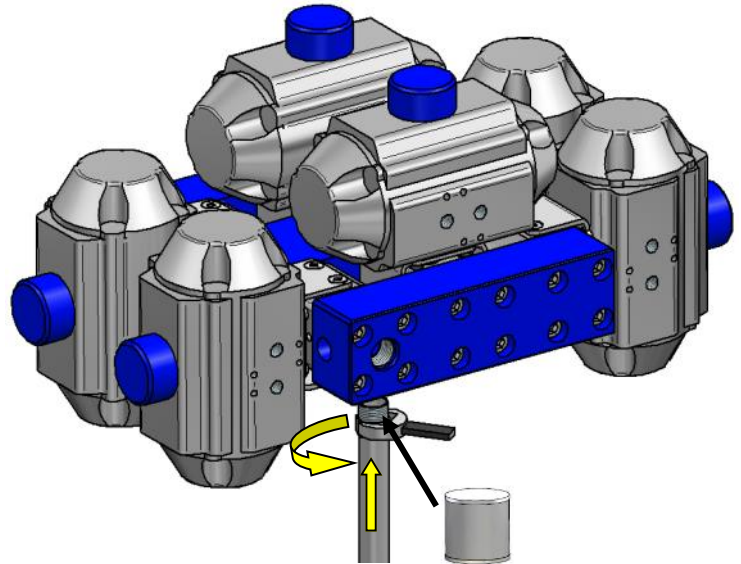

3. Attach second inlet connection.  
**Recommended torque = 50Nm**

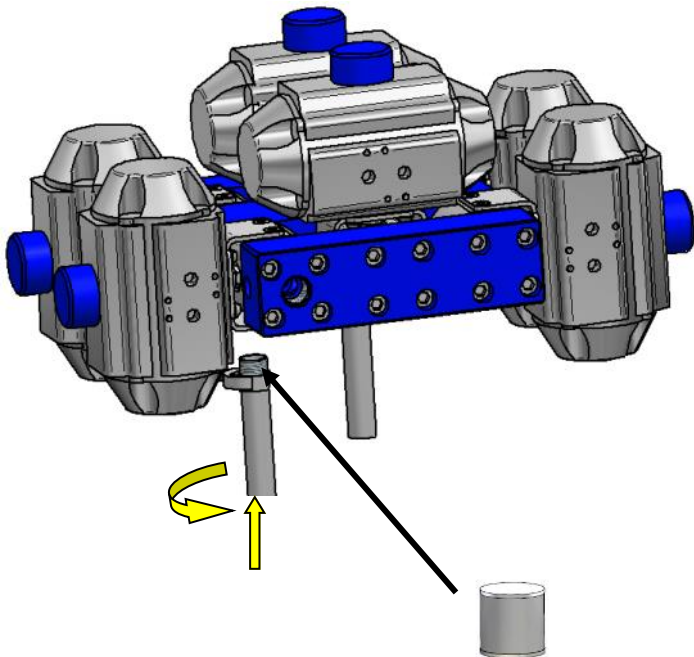

4. Attach third inlet connection.  
**Recommended torque = 50Nm**

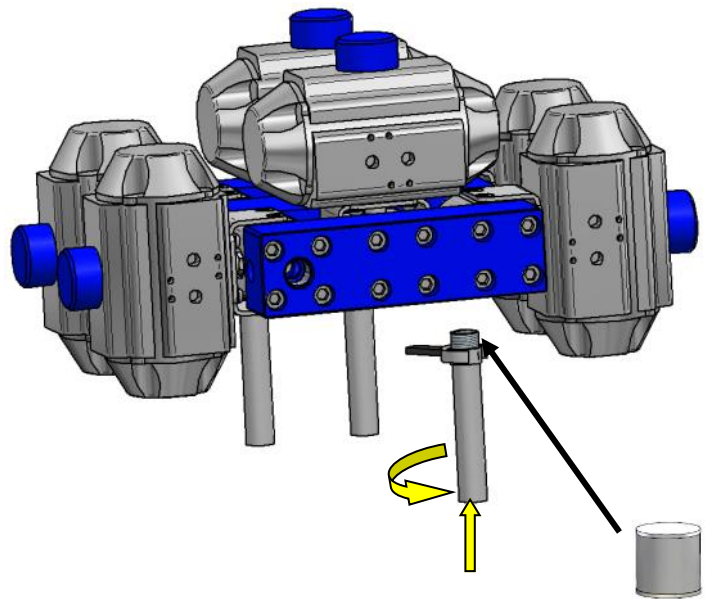

5. Attach outlet connections (times 2).  
**Recommended torque = 50Nm**

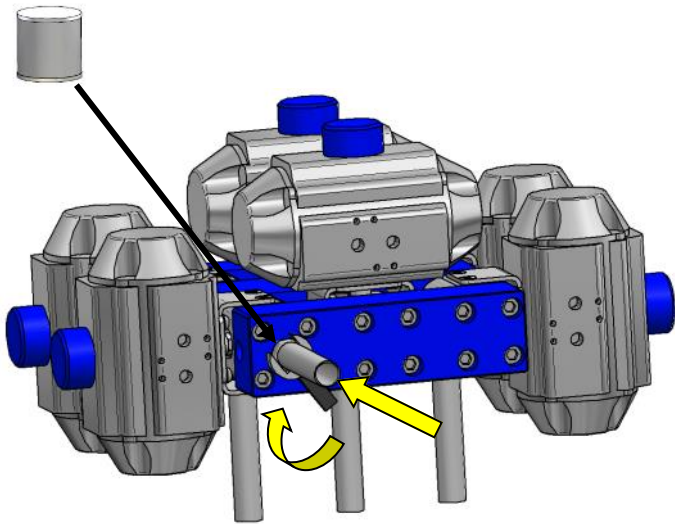

6. Attach actuator 'take off pipe'.  
**Recommended torque = 18Nm**

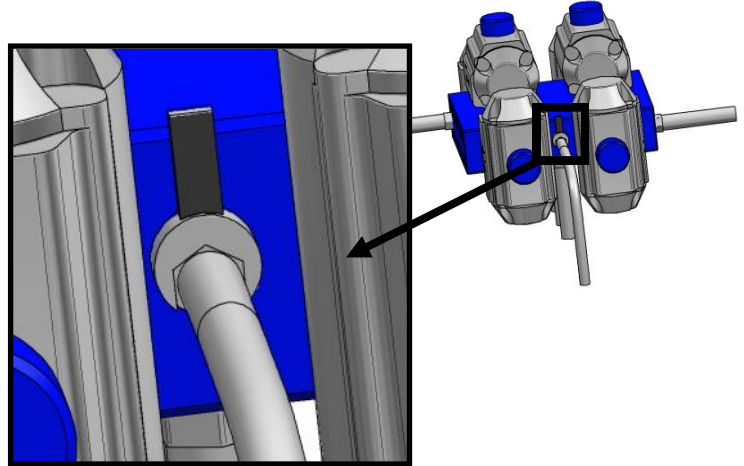

**IF NOT USING THE ACTUATOR  
PORT THIS MUST BE PLUGGED.**

7. Leak test connections with Snoop or soapy water.

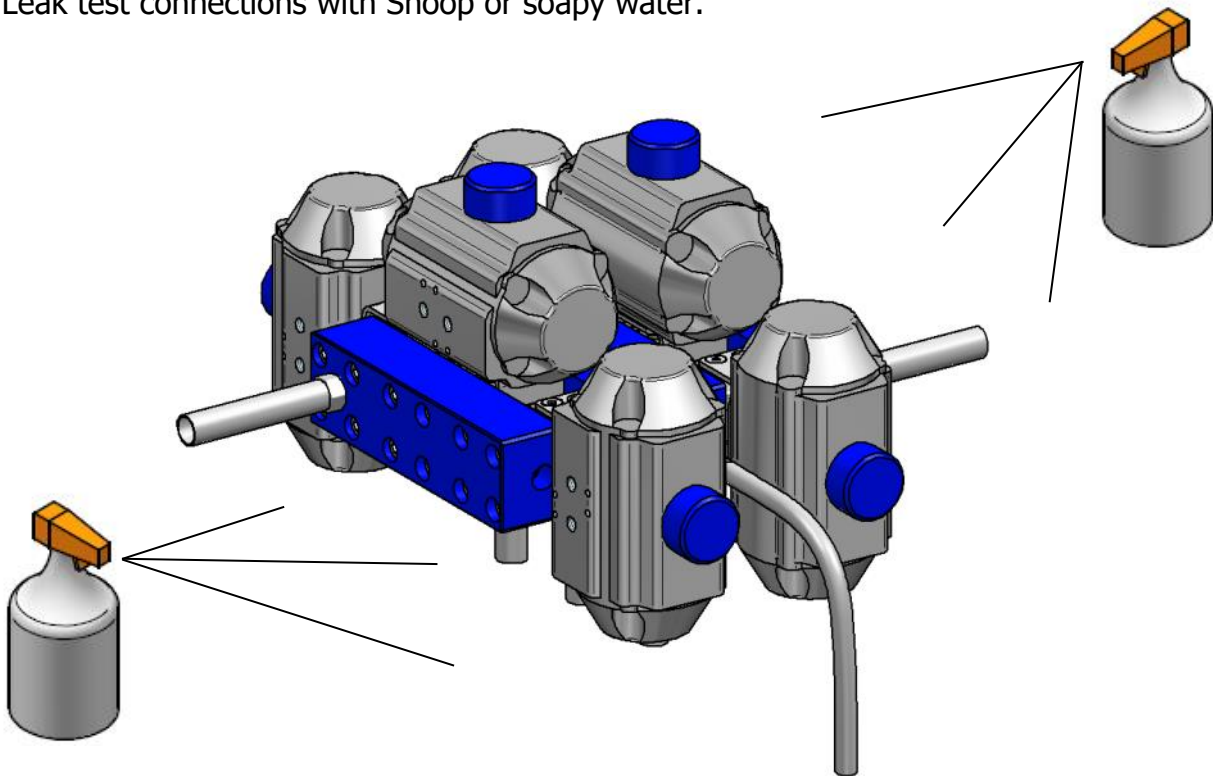

## Connections and mounting

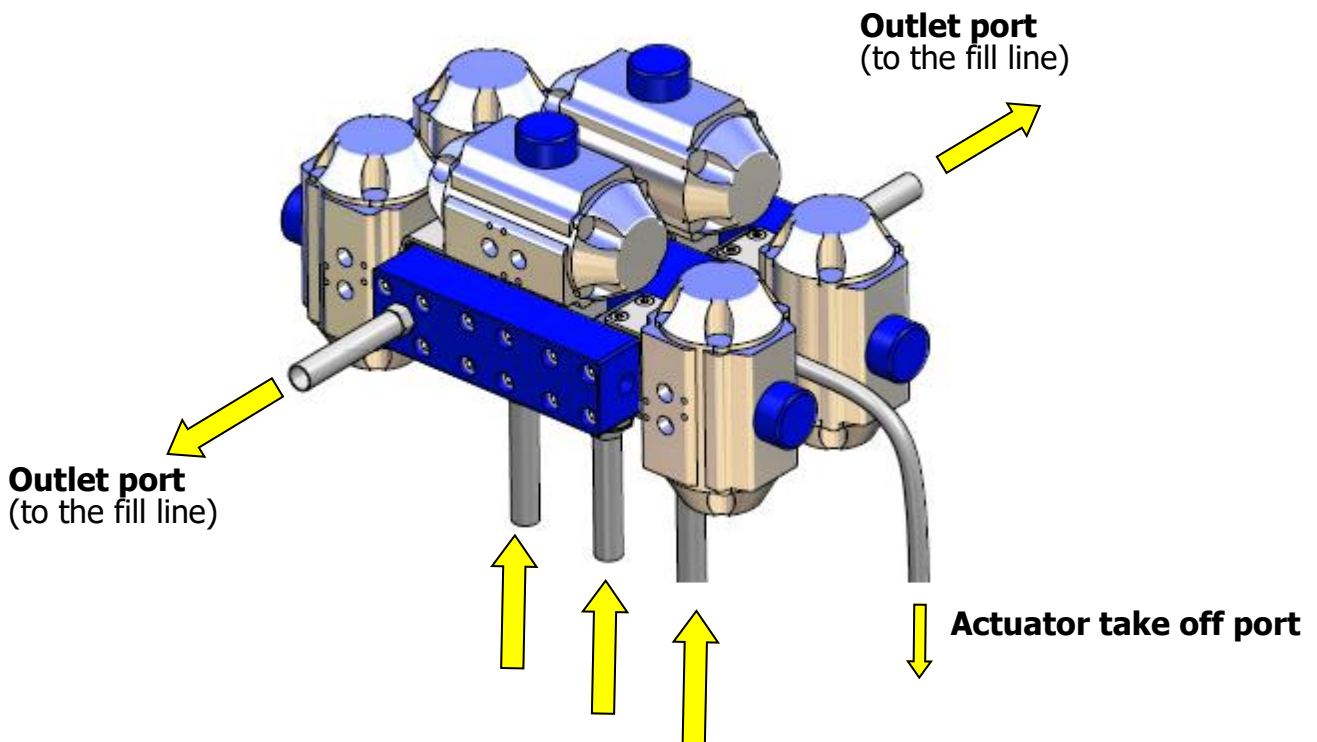
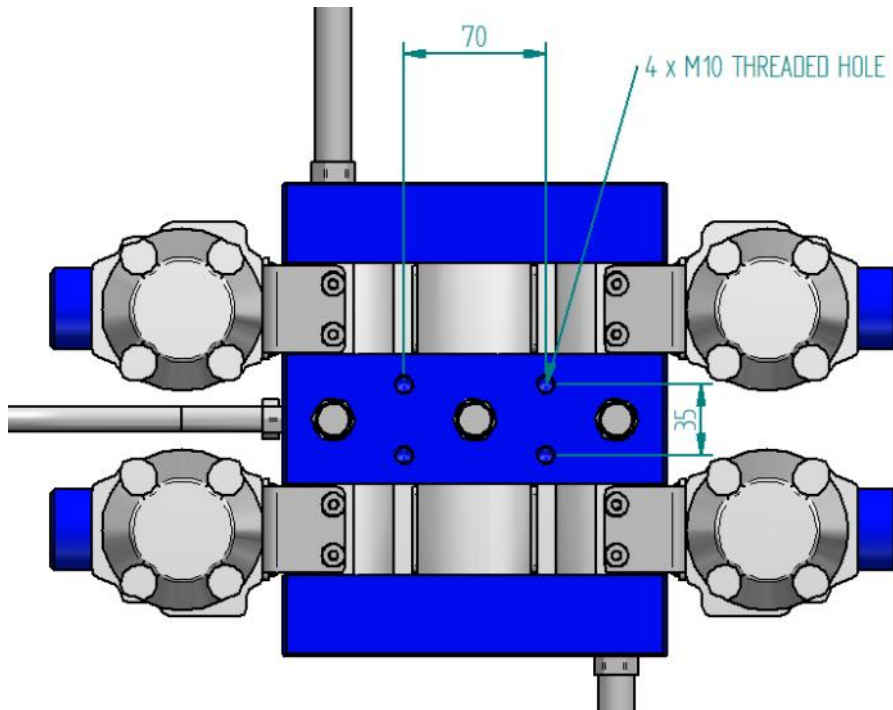

**Inlet ports**  
It is recommended that the low pressure line is connected closest to the actuator take off port

## Service Kit Parts



6 x Sandwich Valve Service Kits

**The Complete Oasis Seal Kit must be used**

## Tools Required

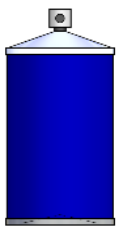

Cleaner  
(Warm Soapy  
Water or Similar)



Pick Tool  
TOOL-PICK  
(Sold separately)



Anti Seize Grease  
(Loctite 771 or Similar)  
For All Threads

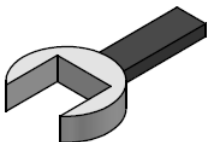

Spanner  
(Wrenches)

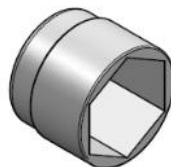

Sockets



Oasis Plastic Tool  
Part Number:  
TOOL-BVASSY  
(Sold separately )  
or Similar

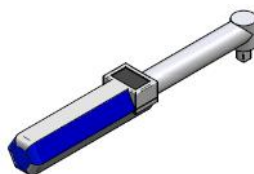

Torque Wrench

1. Remove actuator and take off pipe if used.

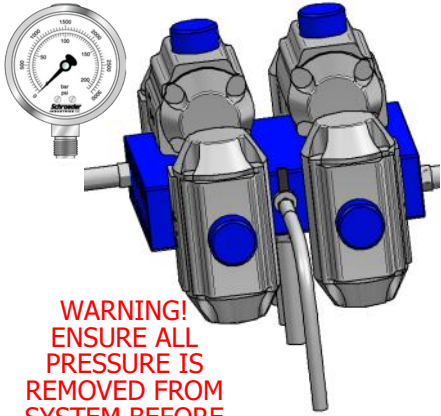

**WARNING!**  
ENSURE ALL  
PRESSURE IS  
REMOVED FROM  
SYSTEM BEFORE  
SERVICING

2. Remove the 2 outlet connections.

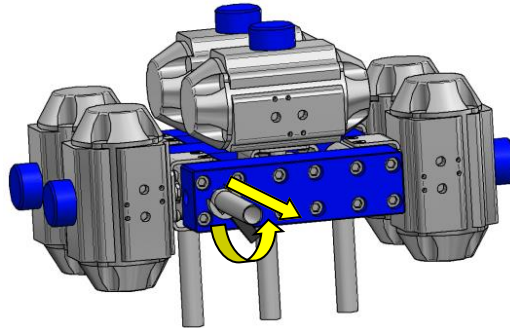

3. Remove first inlet connection.

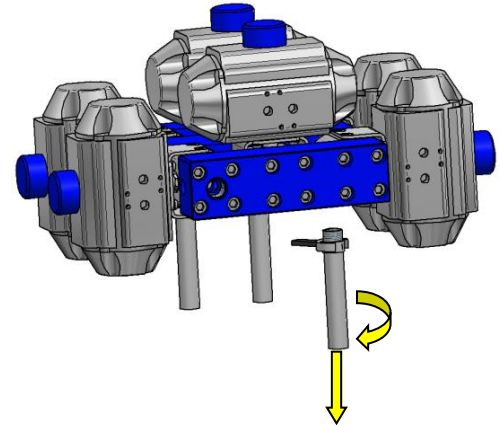

4. Remove second inlet connection.

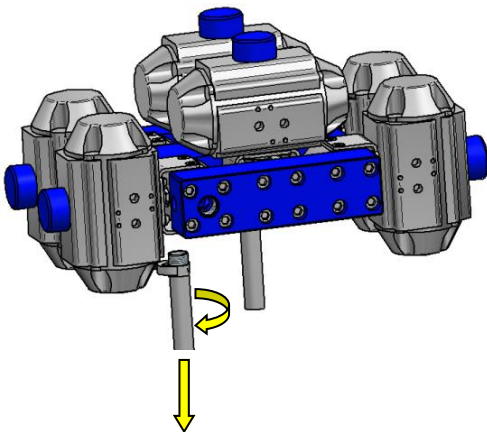

5. Remove the middle inlet connection last.

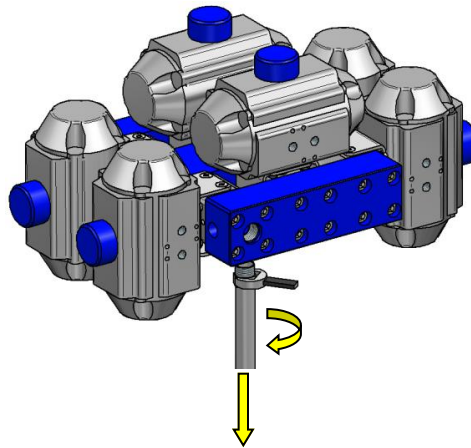

6. Remove from mounting.

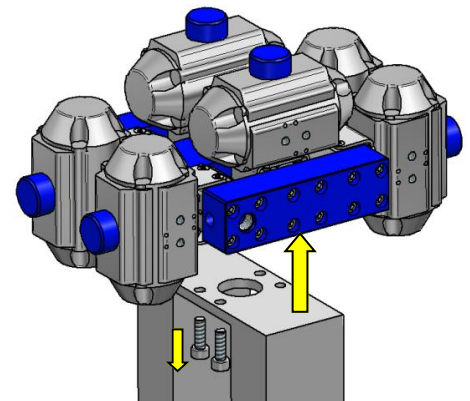

7. Loosen all 24 manifold bolts.

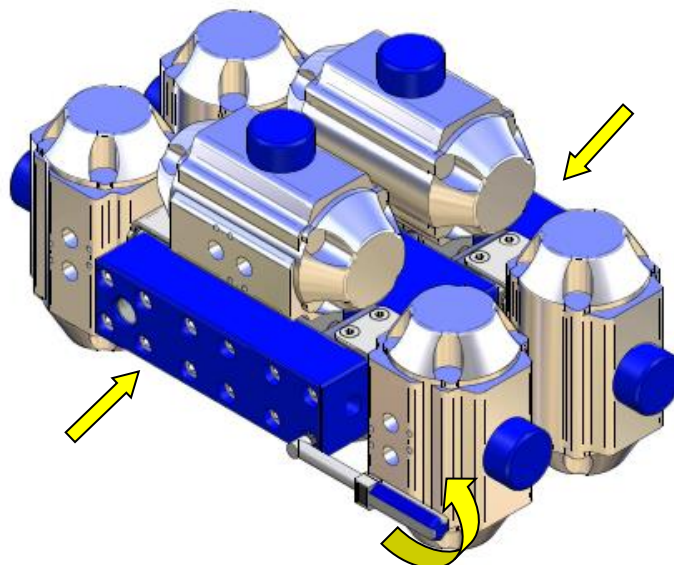

8. Remove the four bolts for end valve.

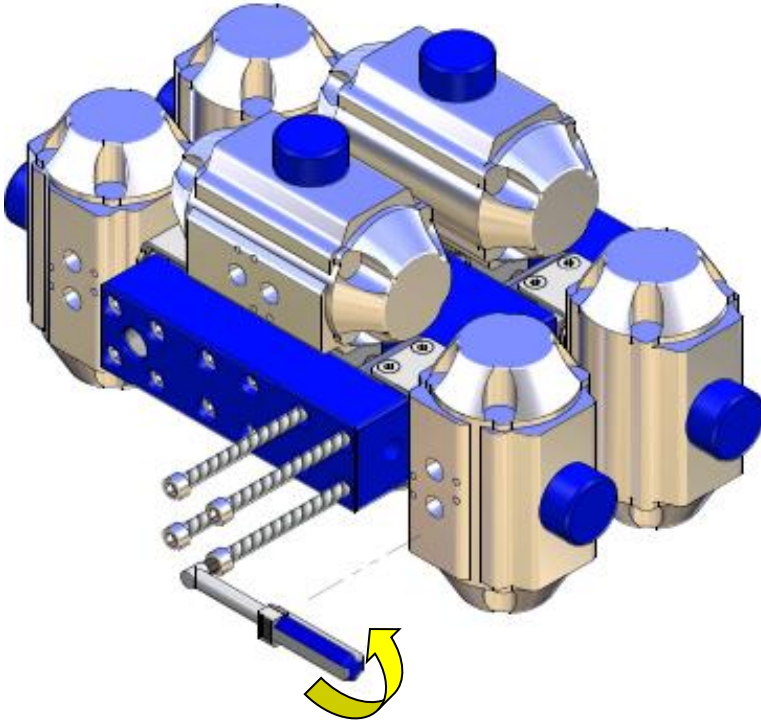

9. Remove the sandwich valve. Repeat this on the other side.

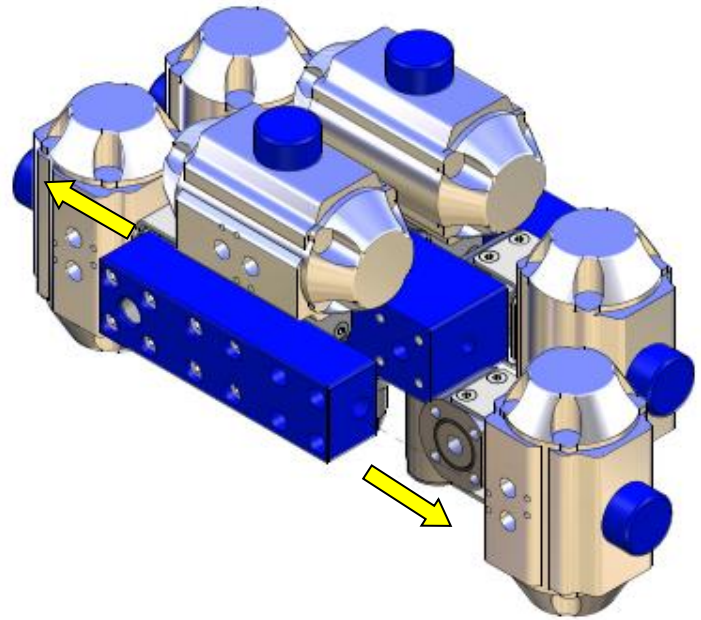

10. Remove the center valve and manifold block.

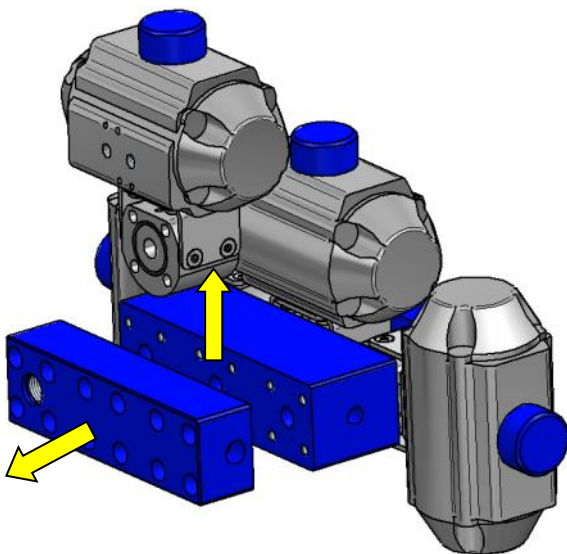

11. Remove the four bolts for end valve

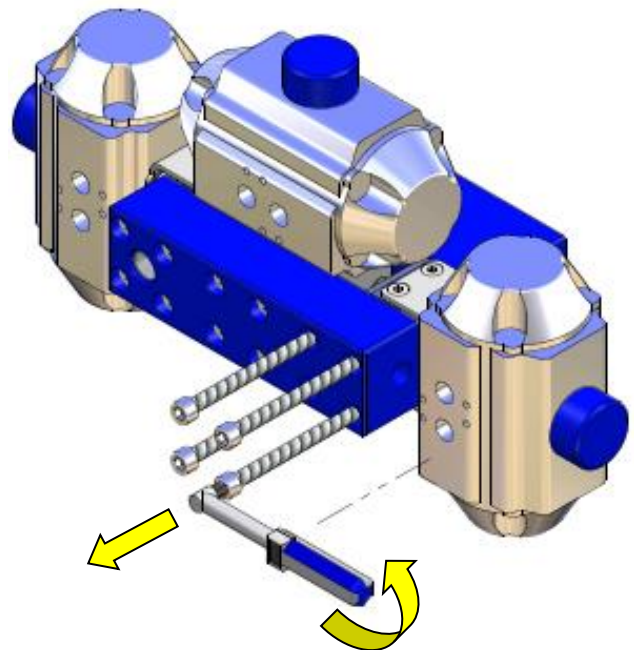



12. Remove the end valve.  
Repeat with remaining valve.

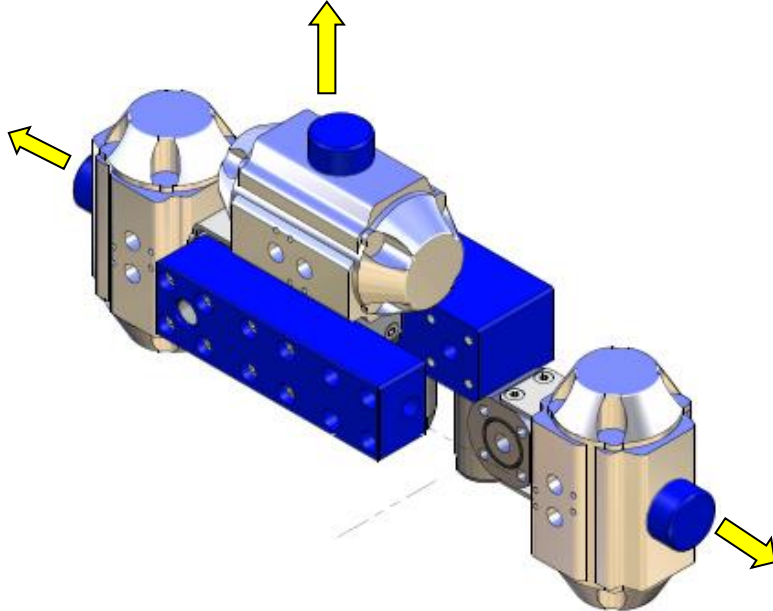

16. Remove the actuator  
from the sandwich valve.

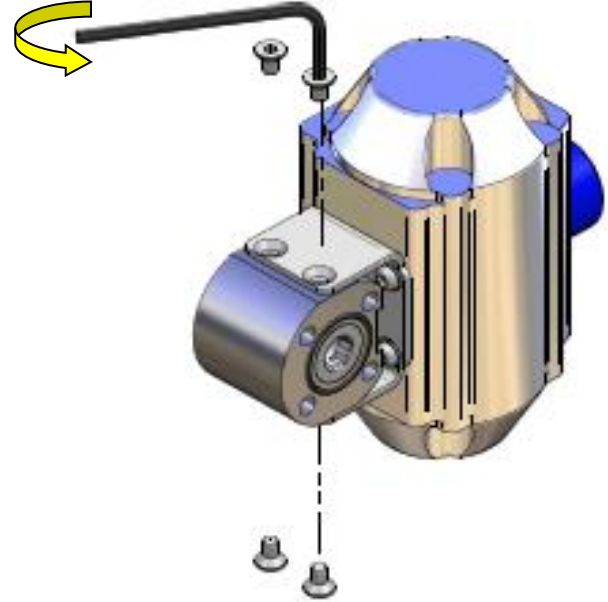

17. Service the sandwich valve.  
Discard the surface O-rings.

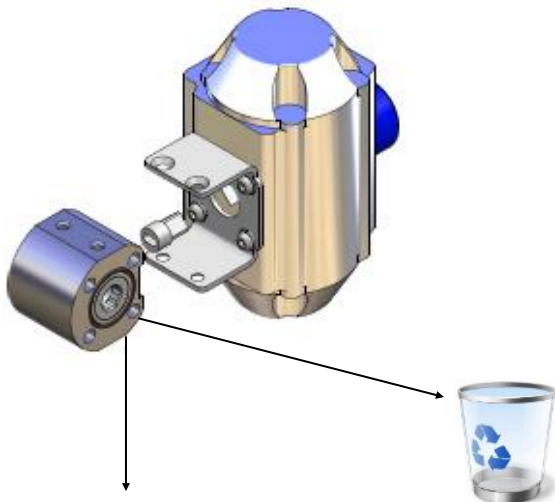

Service the sandwich valve as per the '100 Series Sandwich Valves Servicing Instructions'.

18. Clean components.

Visually inspect  
parts for damage.

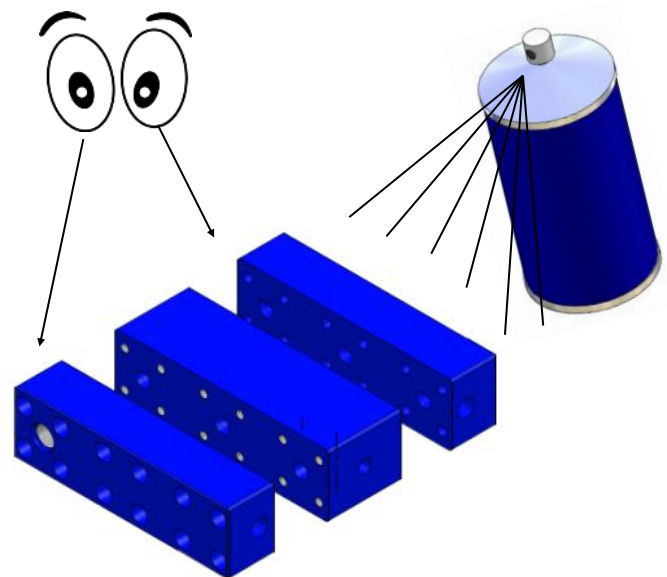

1. Apply silicone grease to surface O-rings then attach. Insert drive dog into valve.

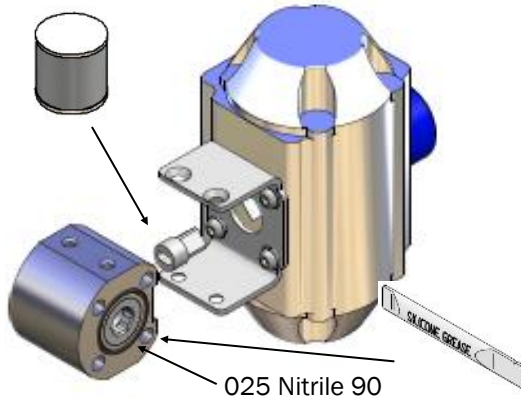

2. Attach the actuator to the sandwich valve.

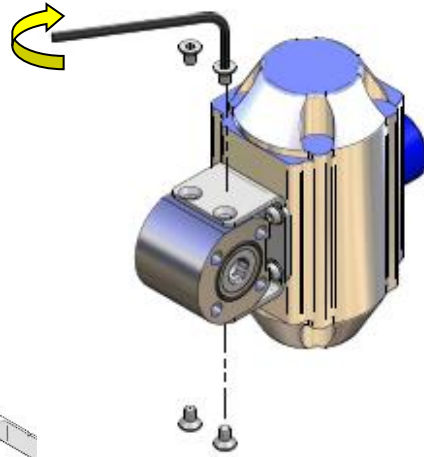

5. Attach center valve and manifold block.

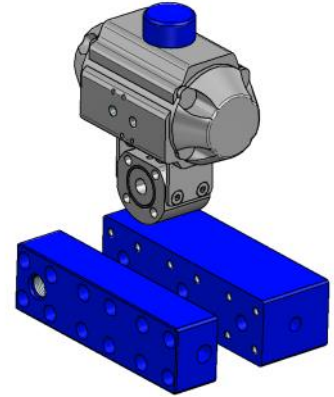

6. Apply anti seize to bolts and screw in loosely. Repeat for next 2 valves.

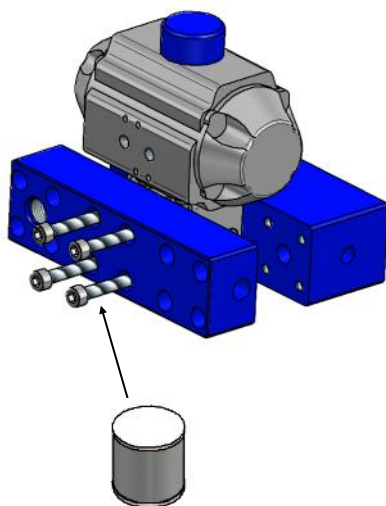

7. Torque all the manifold bolts to 26Nm.

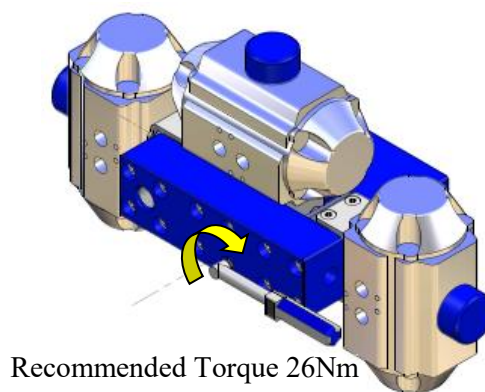

8. Attach second manifold block & center valve.

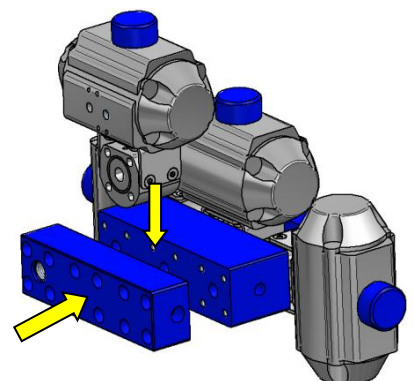

9. Apply anti seize to bolts and screw in loosely. Repeat for the remaining valves.

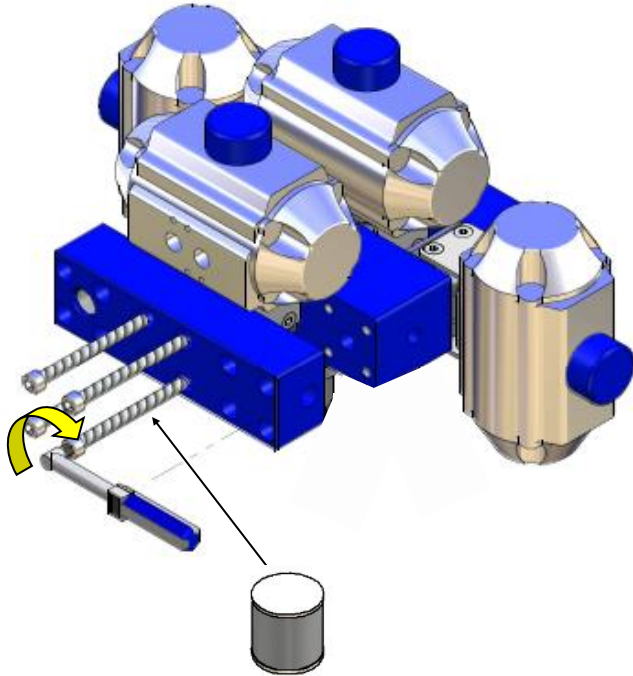

10. Torque all bolts to 26Nm.

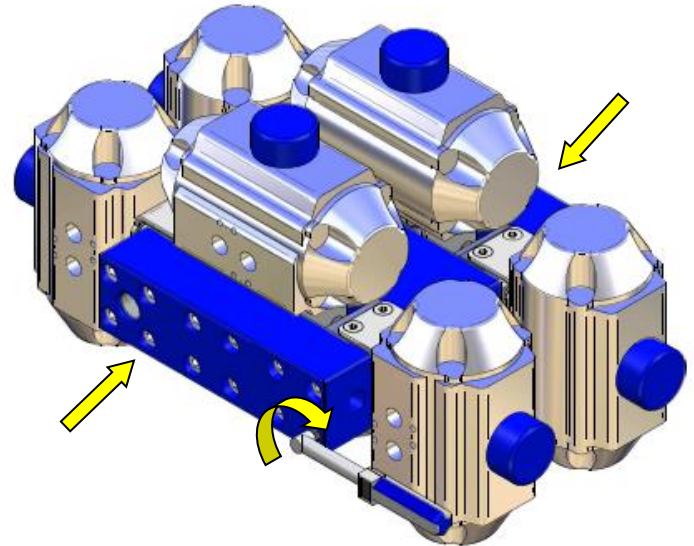

Recommended Torque 26Nm

11. Re-install as instructed on page 3. Test for leaks using snoop or soapy water on first use.

