

PM104

Priority Manifold

Instruction Manual

▲ WARNING

Failure to follow these instructions or to properly install and maintain this equipment could result in gas leakage, fire or explosion causing property damage and personal injury or death.

Oasis products must be installed, operated and maintained by trained and competent personnel in accordance with all applicable local codes, rules and regulations in addition to the Oasis Instructions.

Oasis Engineering Ltd. will not be held liable in such circumstances where installation, operation and maintenance procedures were performed by incompetent personnel resulting in improper assembly, unsafe operation, equipment damage or personal injury.

Oasis Engineering Ltd
129 Birch Avenue, Tauranga, New Zealand.
T: +64 7 928 3808 F: +64 7 928 3809
E: info@oasisNGV.com
W: www.OasisNGV.com

Warning!

High pressure gas and gas equipment can cause serious harm to both infrastructure and personnel if safety precautions are not followed.

Oasis recommends considering the use of the following PPE when working with high pressure along with any other site specific health and safety requirements:



Foot Protection



Hearing Protection



Safety Helmets



Hand Protection



Safety Glasses



Ensure the system is clean of debris, vented and isolated before any installation or servicing work is carried out.

Tools Required

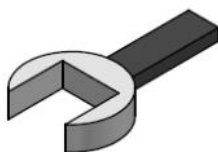

Spanner
(Wrenches)



Thread Tape



Anti Seize Grease
- Swagelok Silver Goop
- Omega 99
- or similar

1. Mount the panel (see mounting on page 4 for dimensions).

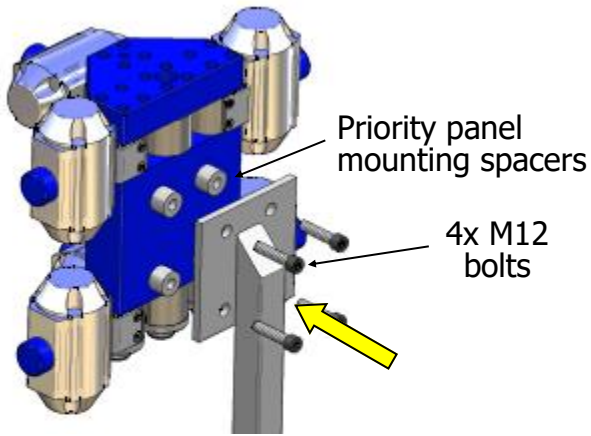

2. Install gauges and pressure transducers.

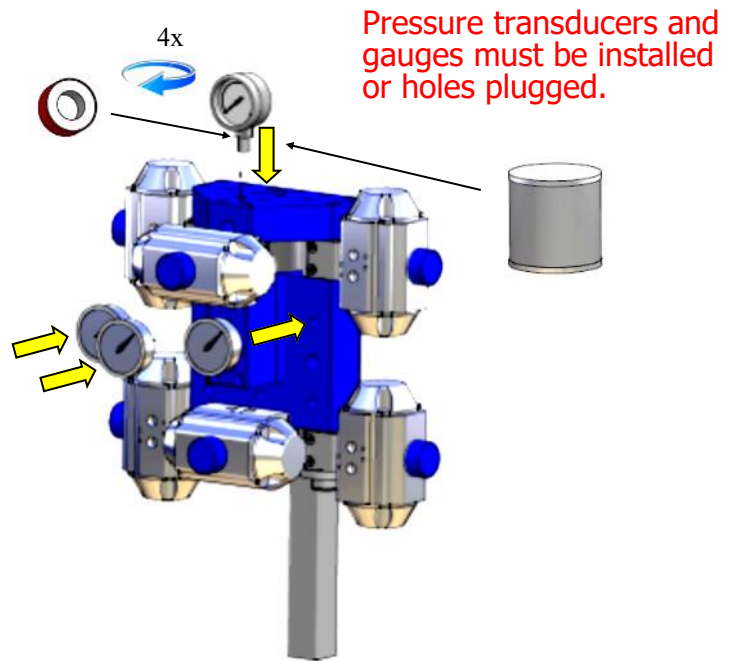

3. Mount the connections as required. (see P&ID on page 4)

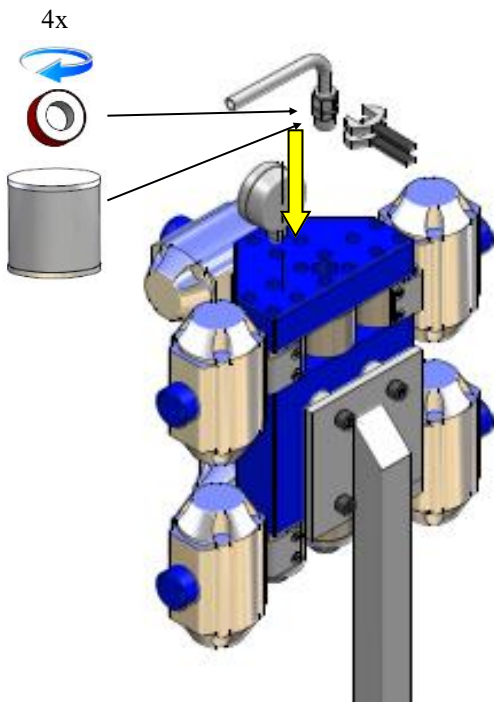

4. Installation complete, check all connections for leaks on first use with snoop or soapy water.

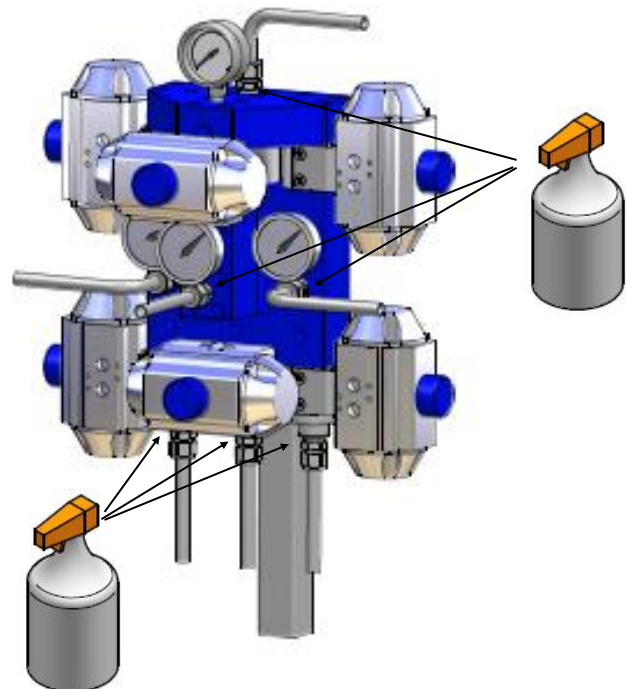

5. Port locations

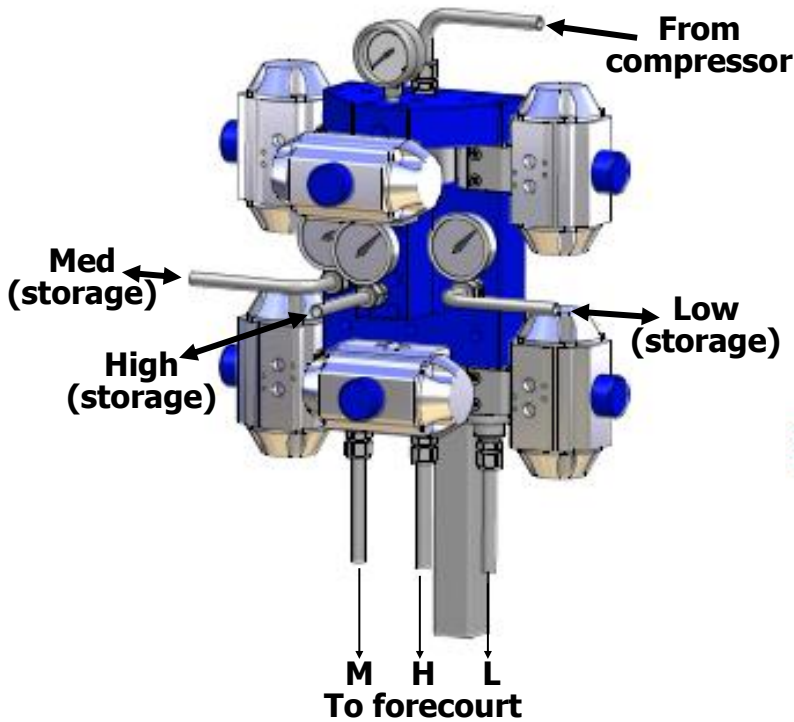

6. Mounting.

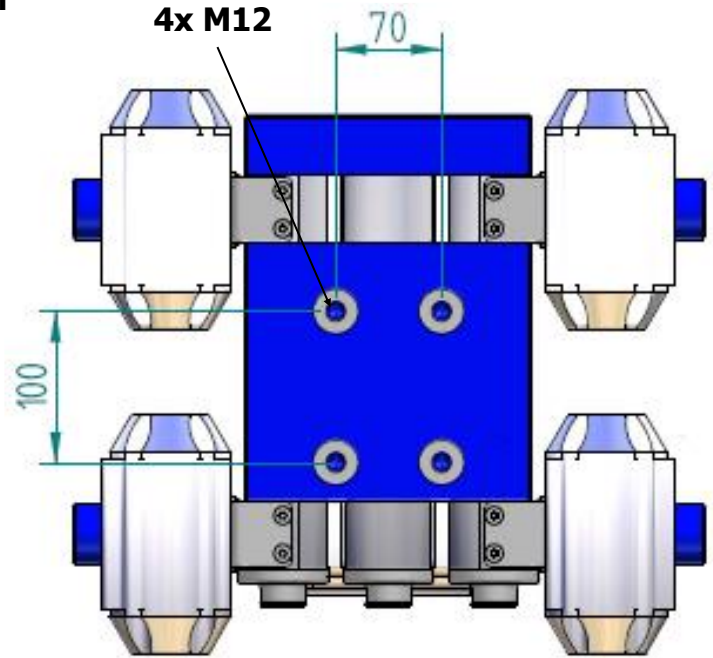

7. P & ID.

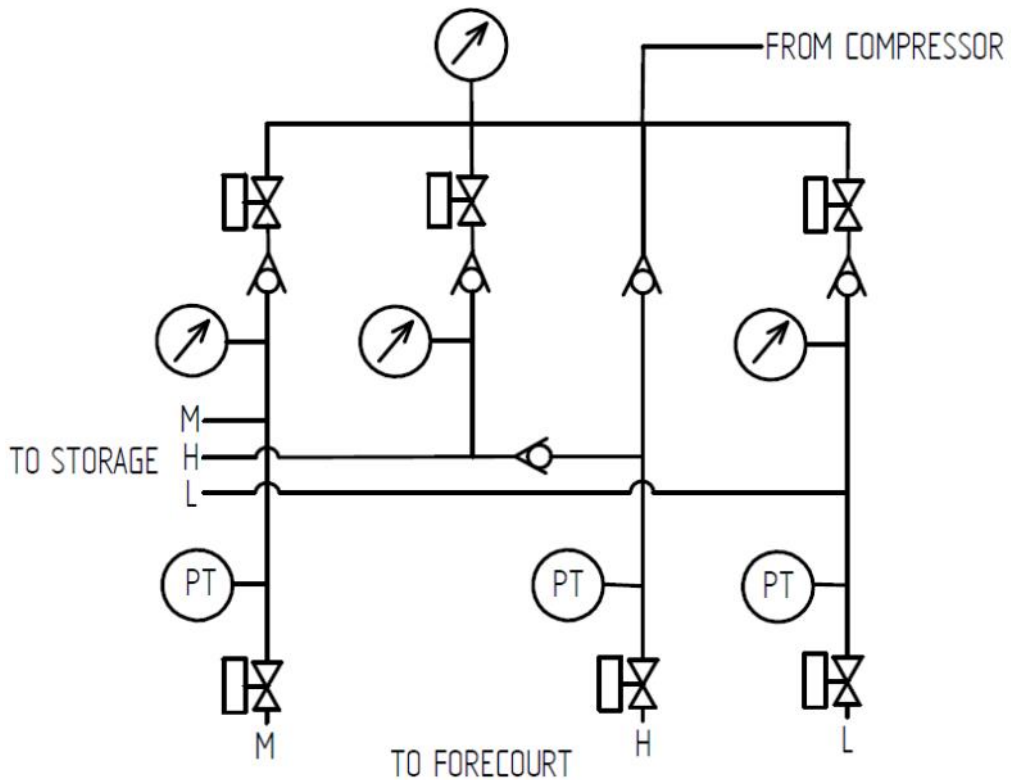

Service Kit Parts

PM104-LTD-SAE-ASM



2 x Sandwich Valve Surface O-rings (025 Nitrile 90)



5 x Sandwich Valve Service Kits



5 x Check Valve Poppets



5x Check Valve Springs



1 x Silicone grease



5 x Check Valve O-rings

PM104-STD-SAE-ASM



5 x Check Valve O-rings.



6 x Sandwich Valve Service Kits



5 x Check Valve Poppets



5 x Check Valve Springs



1 x Silicone grease

The Complete Oasis Seal Kit must be used

Tools Required

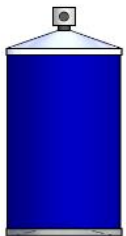

Cleaner (Warm Soapy Water or Similar)



Anti Seize Grease (Loctite 771 or Similar) For All Threads

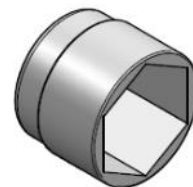

Sockets

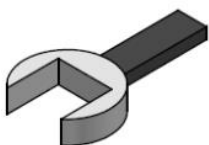

Spanner (Wrenches)



Pliers

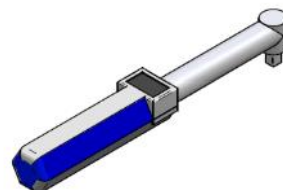

Torque Wrench

1. Ensure the system is depressurized and the priority panel is isolated from all pressure sources.

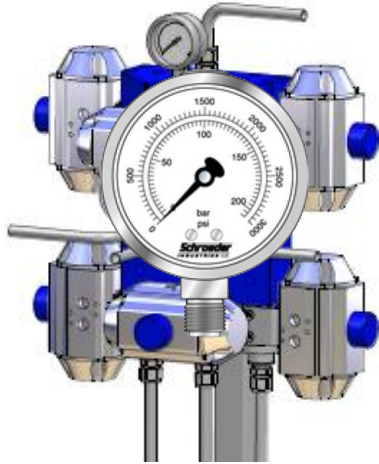

2. Remove all connections and gauges.

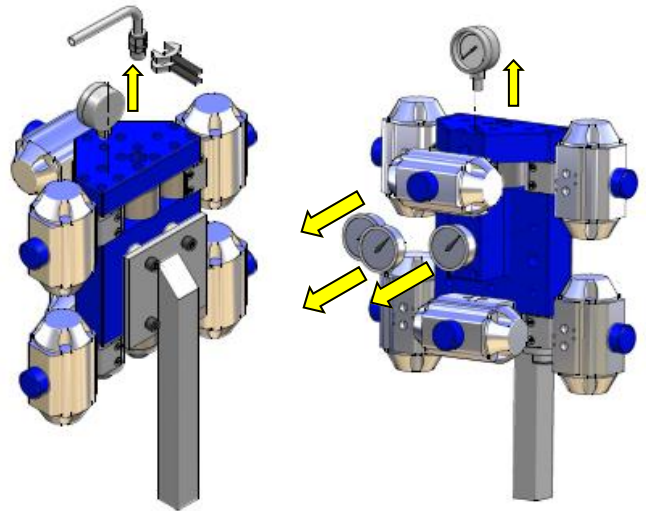

3. Remove the panel from its mounts.

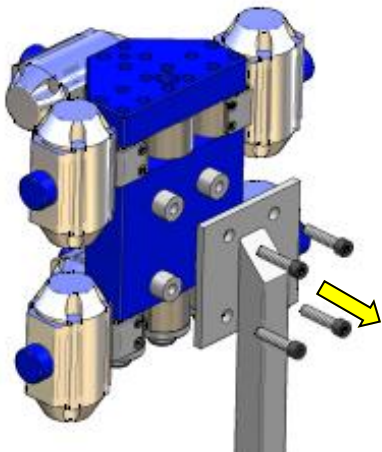

4. Remove sandwich valve bolts.

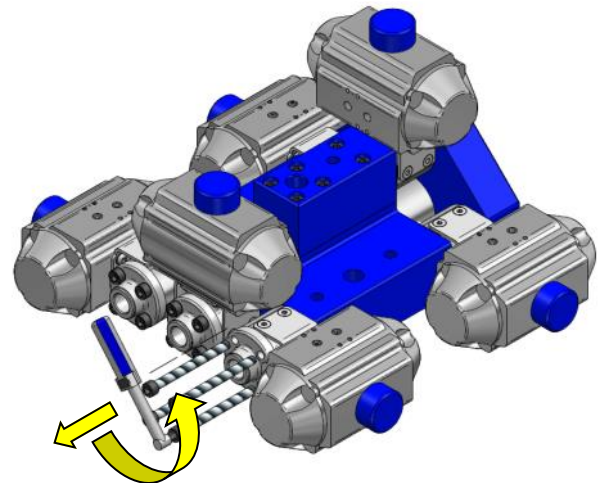

5. Remove sandwich valve, repeat with other two valves.

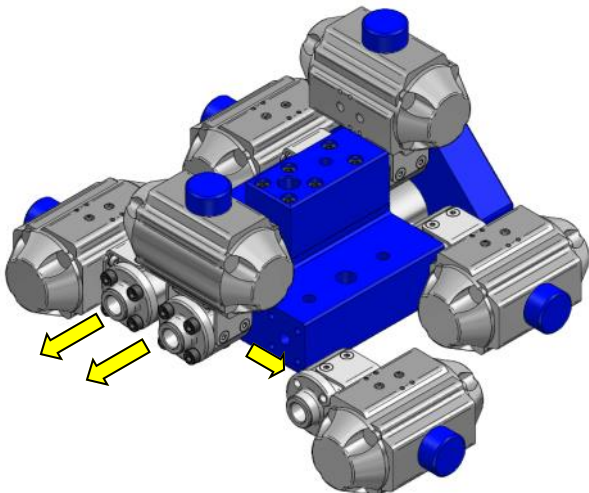

6. Loosen all bolts at compressor end.

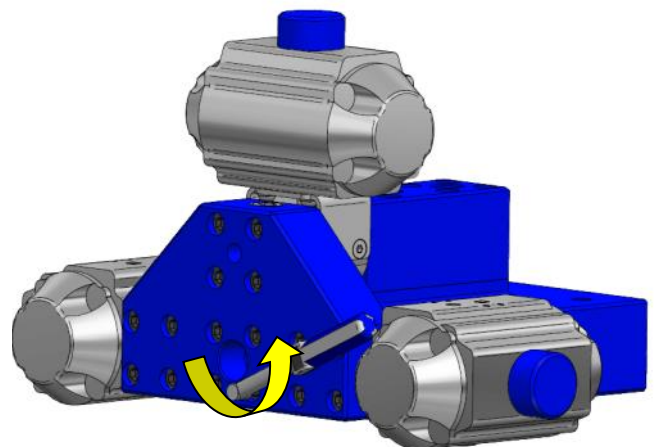

7. Remove four bolts and remove sandwich valve. Repeat with the other two valves.

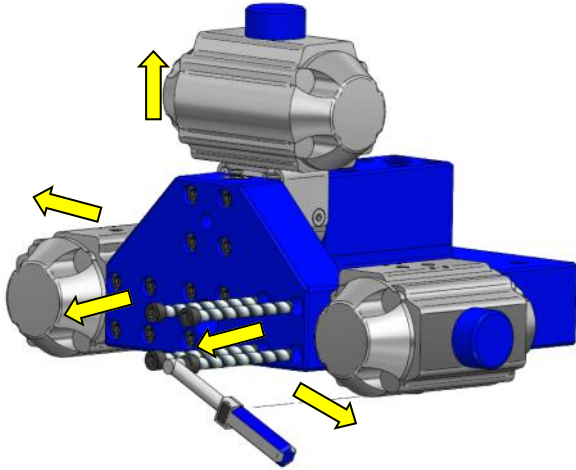

8. Remove center bolts last.

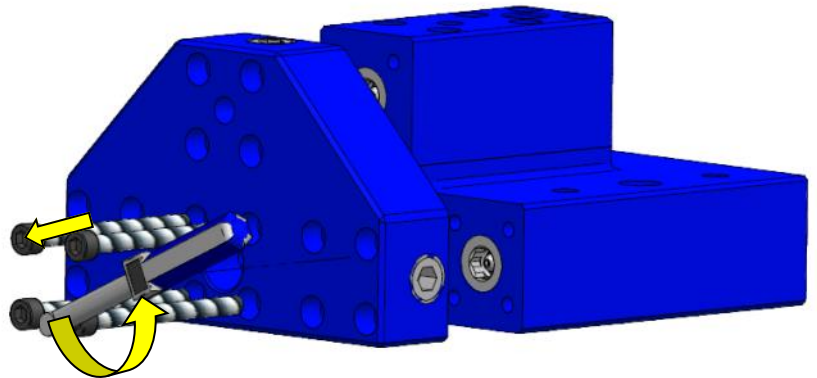

9. Remove spacer.

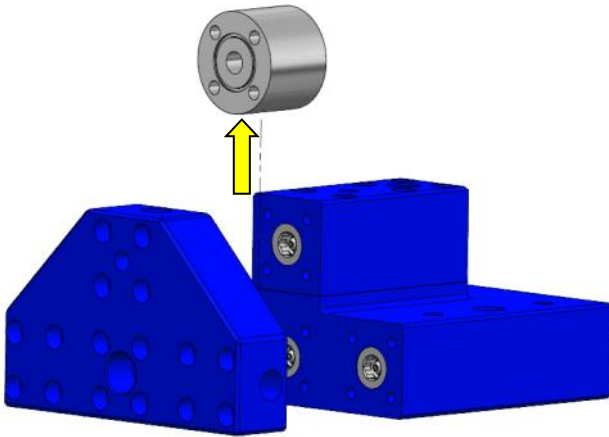

10. Remove check valves.

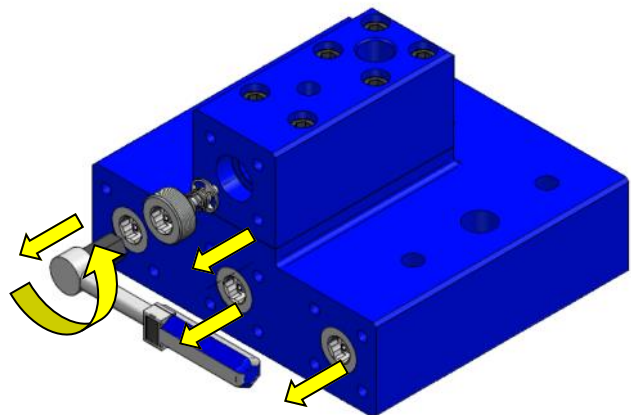

11. Remove high pressure block.

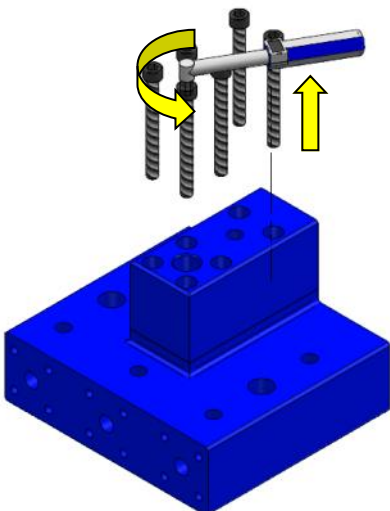

12. Discard O-ring.

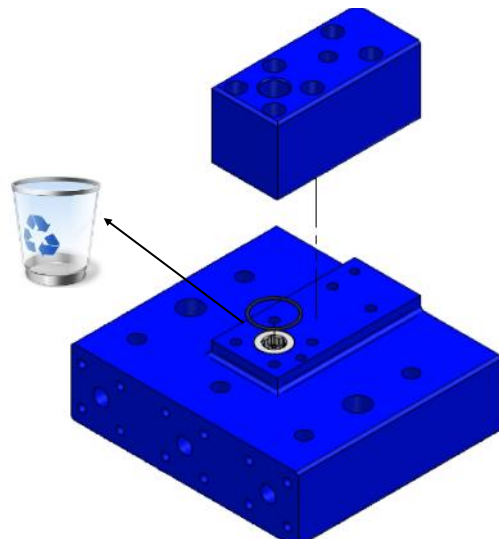

13. Remove check valve.

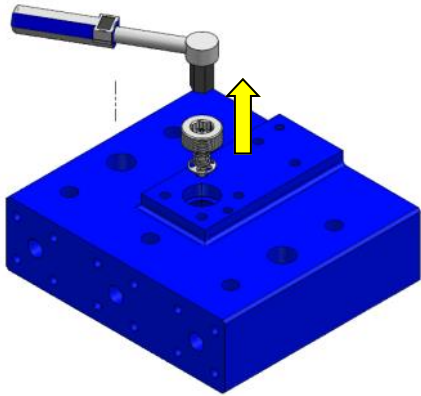

14. Discard check valve,
O-ring, poppet and spring.



15. Service the sandwich valves.
Discard drive dog.

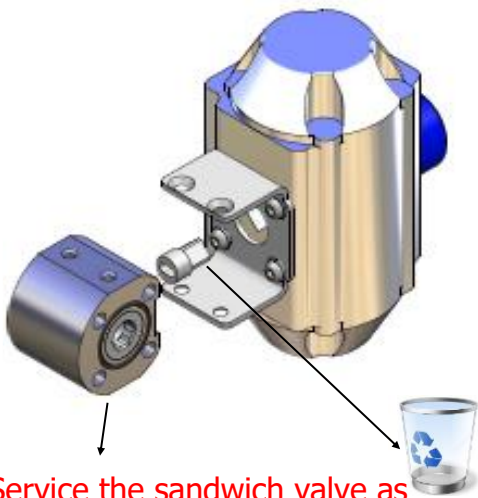

Service the sandwich valve as
per the '100 Series Sandwich
Valve Servicing Instructions'.

16. Clean components and inspect for damage.

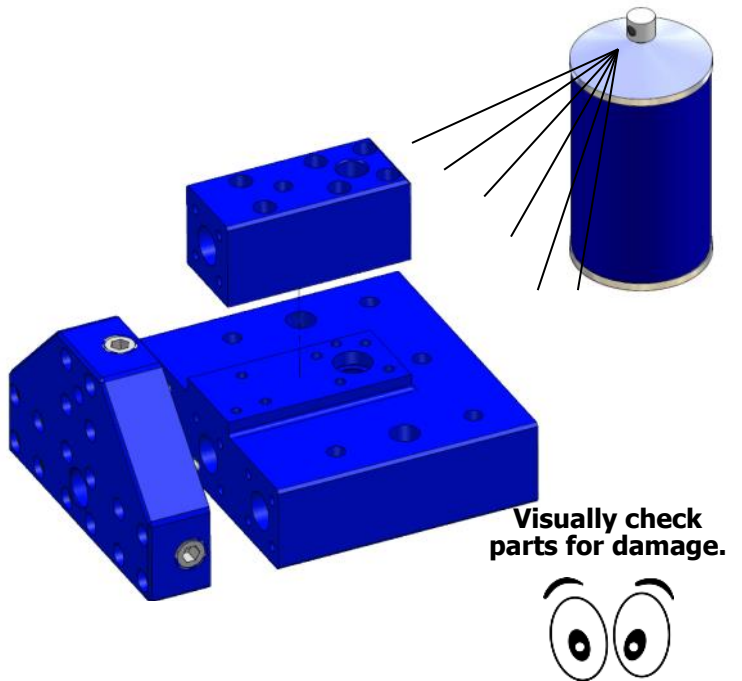

1. Assemble check valves.

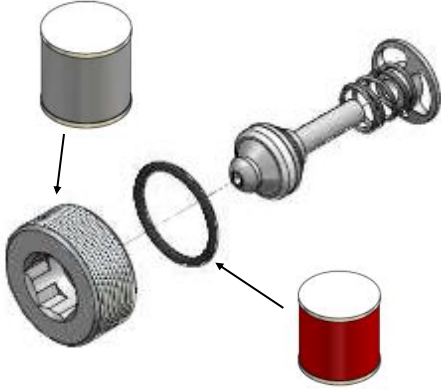

2. Insert check valve and torque to 35Nm.

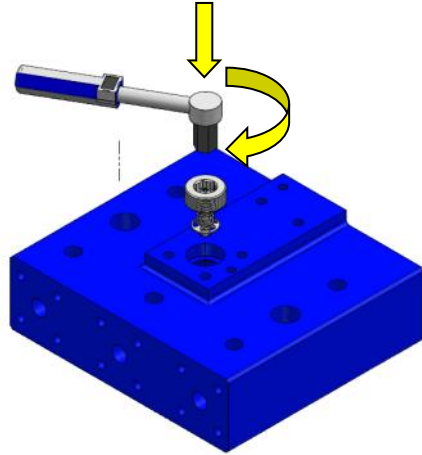

3. Grease O-ring and attach high pressure block.

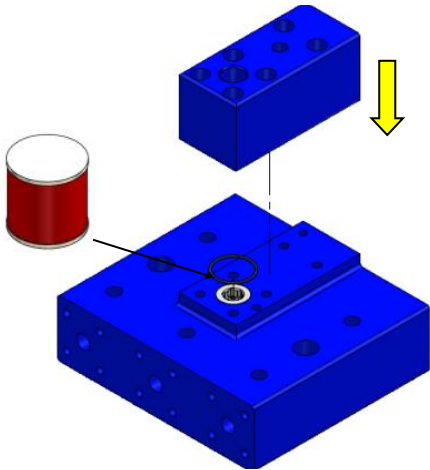

4. Torque down high pressure block 37Nm.

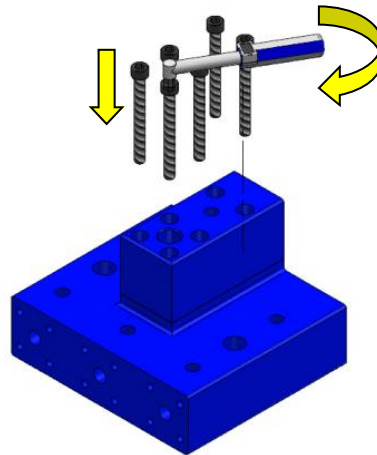

5. Insert check valves and torque to 35Nm

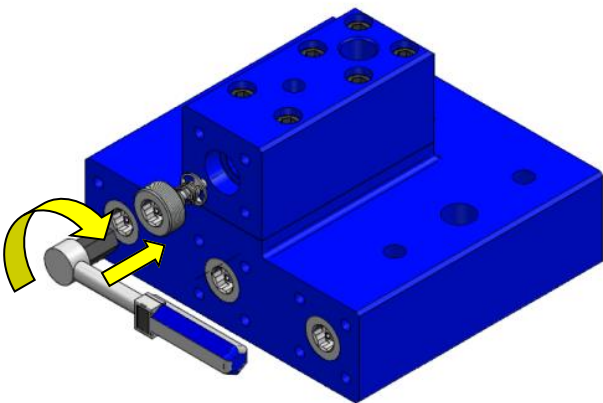

6. Add O rings to spacer and place between manifolds.

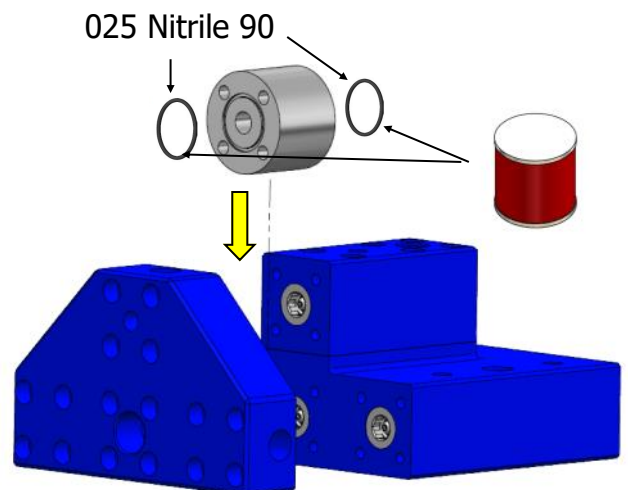

7. Insert the four center bolts and leave loose.

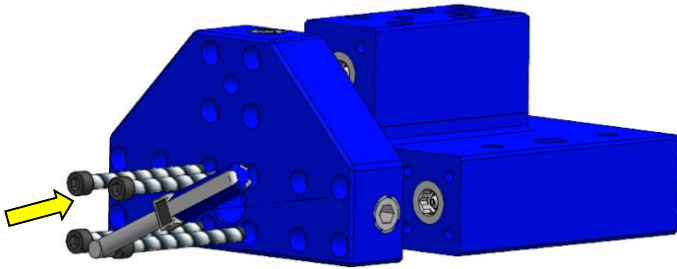

8. Insert serviced valve with new O-rings.

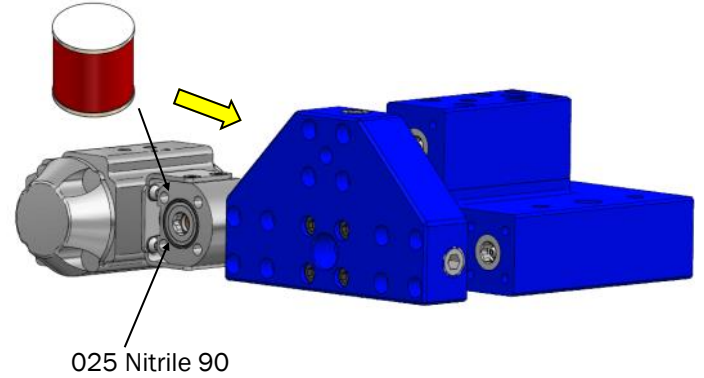

9. Attach first sandwich valve to compressor end.

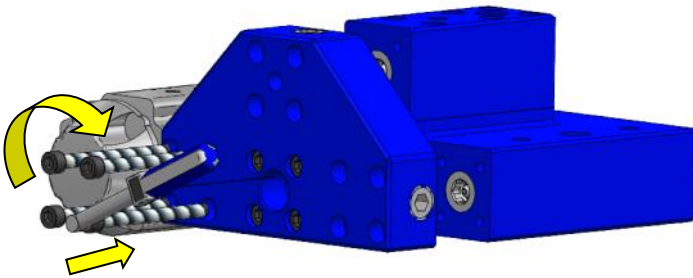

10. Attach remaining sandwich valves to compressor end.

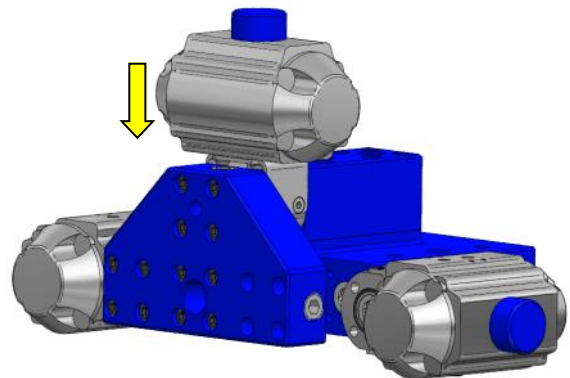

11. Torque all sandwich valve bolts to 37Nm.

12. Attach sandwich valve on forecourt side.

Torque pattern

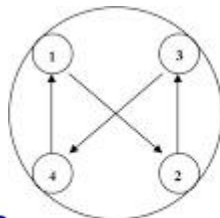

Four-Bolt

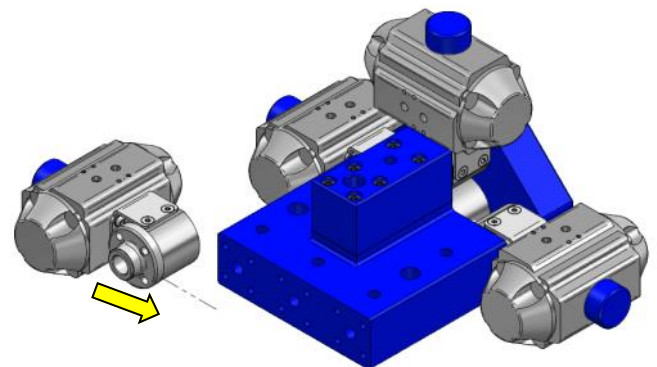
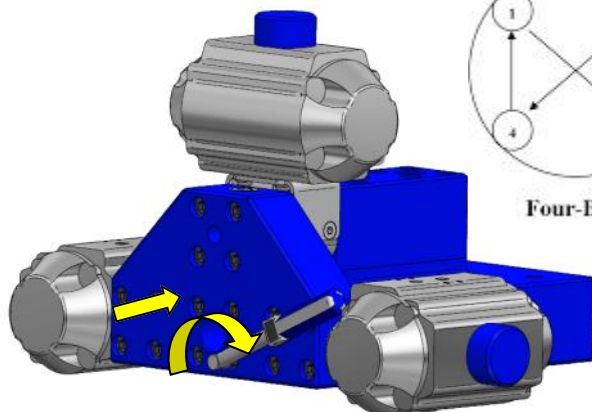

13. Attach forecourt side sandwich valves.

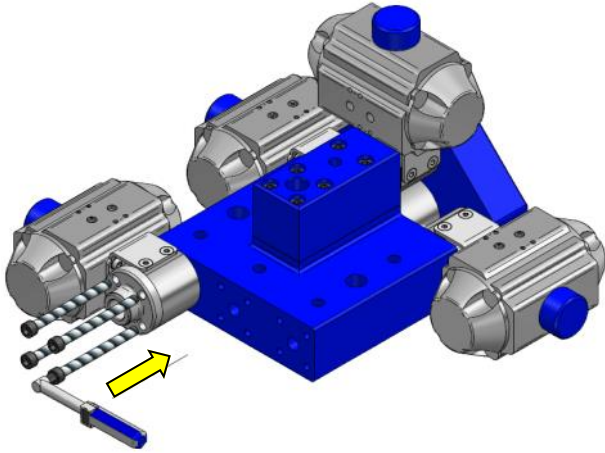

14. Add sandwich valve bolts, torque all to 37 Nm

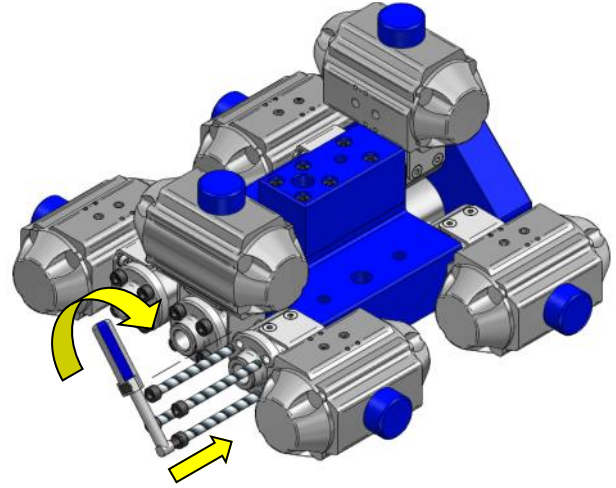

15. Servicing complete, following installation instructions on page 3 for re-fitment of manifold.

