



700 Series Ball Valve with Code 62 Adapter

Applications

CNG Compressors, Isolation Valves and Storage. Suitable for CNG, Helium, Bio-Gas and Nitrogen, Air and other gases on enquiry.



BV706-4Y6LDDN-M000 - Ball Valve with Code 62 Adapters

Materials

| Item | Part | Material |
|------|-------|---------------------|
| 1 | Body | 304 Stainless steel |
| 2 | Cap | 304 Stainless steel |
| 3 | Stem | 316 Stainless steel |
| 4 | Ball | 316 Stainless steel |
| 5 | Seats | Delrin |

| Item | Part | Material |
|------|----------------|---------------------|
| 6 | Seat O-rings | Nitrile |
| 7 | Gland & Thrust | Delrin |
| 8 | Body O-rings | Nitrile |
| 9 | Stem O-rings | Nitrile |
| 10 | Handle | 304 Stainless Steel |

Product Information

Custom handle options available on request.

NPT/SAE threaded ports available from stock. Other thread types available upon request.

NPT threads conform to ASME B1.20.1.

SAE threads conform to SAE J1926-1.

Code 62 flanges conform to SAE J518-2.

All products are manufactured to ISO 9001 standards.

Complies to PED 2014/68/EU.

CRN (OC12117.2C) approved for all provinces.

Video servicing instructions available online at www.OasisNGV.com/resources

Features & Benefits

The 700 Series Ball Valve is a FULL FLOW, Anti Blowout stem, all stainless steel certified bar stock, two-piece, serviceable valve.

Service kits are readily available & easy to install.

CNC machining allows tighter tolerances to be maintained, which extends the working life of the components.

The complete Oasis range has been cycle tested to ensure **LOWEST LIFE COST.**

Easy servicing with high flow Code 62 flanges .



700 Series Ball Valve with Code 62 Adapter

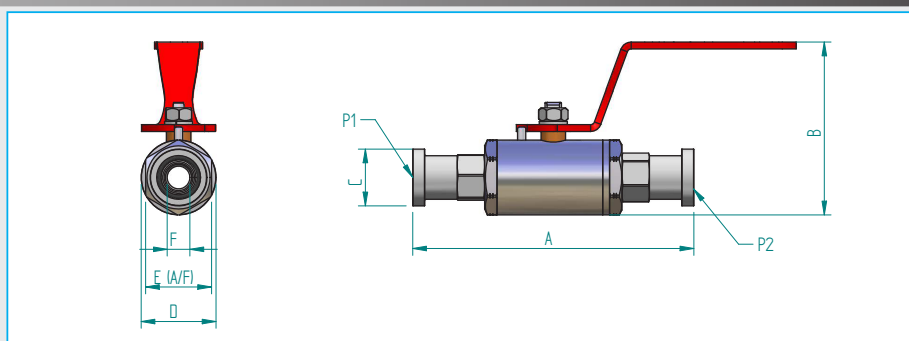

BV706-4Y6LDDN-M000

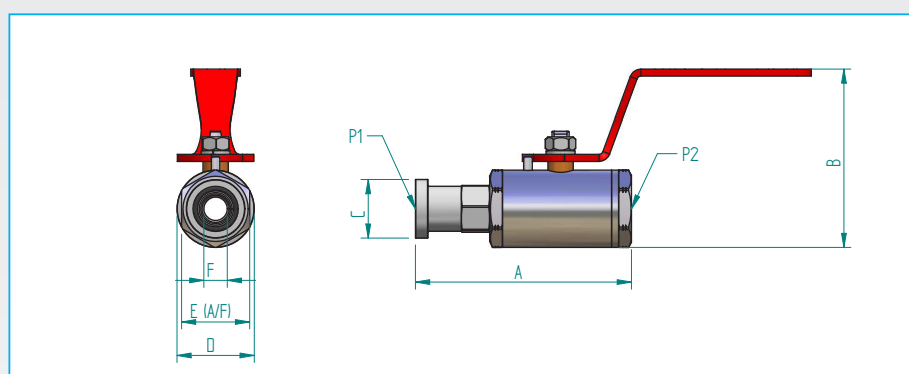

BV706-4X6LDDN-M000 & BV706-4Z6LDDN-M000

Dimensions Inch (mm)

| Part Code | Size | A | B | C | D | E | F (bore) | Port P1 | Port P2 |
|--------------------|------|------------------|----------------|-----------------|---------------|--------------|----------------|--|---|
| BV706-4X6LDDN-M000 | 3/4" | 5.98" (152) | 4.96" (126) | 1.63" (41.3) | 2.16" (55) | 1.9" (48) | .65" (16.5) | 3/4" Code 62 Flange As per SAE J518-2 | 1 1/16-12" SAE FEMALE |
| BV706-4Y6LDDN-M000 | 3/4" | 8.06" (204.7) | 4.96" (126) | 1.63" (41.3) | 2.16" (55) | 1.9" (48) | .65" (16.5) | 3/4" Code 62 Flange As per SAE J518-2 | 3/4" CODE 62 ADAPTER AS PER SAE J518-2 |
| BV706-4Z6LDDN-M000 | 3/4" | 5.98" (152) | 4.96" (126) | 1.63" (41.3) | 2.16" (55) | 1.9" (48) | .65" (16.5) | 3/4" Code 62 Flange As per SAE J518-2 | 3/4" NPT FEMALE |

Product Specification

| Part Code | Mass lb (kg) | Min. Operating Pressure bar (psi) * | Max. Operating Pressure bar (psi) ** | Min. Temp. °F (°C) | Max Temp. °F (°C) | Cycles Before Rekit [^] | Stem Open Torque ft-lb (Nm) ^{^^} | Cv | Service Kit |
|--------------------|-----------------|--|---|--------------------------|-------------------------|--|---|------|------------------|
| BV706-4X6LDDN-M000 | 4.4 (2) | 0.5 (7) | 410 (6000) | -40 (-40) | 185 (85) | 100,000 | 22.8 (31) | 21.9 | BV706-SK6LDDN-62 |
| BV706-4Y6LDDN-M000 | 5 (2.3) | 0.5 (7) | 410 (6000) | -40 (-40) | 185 (85) | 100,000 | 22.8 (31) | 21.9 | BV706-SK6LDDN-62 |
| BV706-4Z6LDDN-M000 | 4.4 (2) | 0.5 (7) | 410 (6000) | -40 (-40) | 185 (85) | 100,000 | 22.8 (31) | 21.9 | BV706-SK6LDDN-62 |

* Minimum system pressure the product will hold constant bubble tight seal.

** Maximum pressure at which the product can constantly operate at.

[^] It is recommended that the ball valve is re-kitted on or before the maximum number of allowable cycles.

^{^^} Opening torque at 6,000 psi

We reserve the right to modify product specifications without prior notice.